

**PT-2/HALF YEARLY EXAMINATION, 2022-23**  
**MATHEMATICS**

Time - 11:30 AM to 02:45 PM

Class - IV

M.M. : 80

Date – 07.9.2022 (Wednesday)

Name of the student \_\_\_\_\_ Section \_\_\_\_\_

**GENERAL INSTRUCTIONS:**

- This question paper comprises 23 Questions in two sections: Section A and Section B.
- Section A contains 10 questions. Q.No. 1 and 2 carries 1 mark each, Q.No. 3 to 10 carries 2 marks each.
- Section B contains 13 questions. Q.No. 11 to 16 carries 3 marks each, Q.No 17 to 19 carries 4 marks each, Q.No. 20 to 23 carries 5 marks each.
- All questions are compulsory

**Section – A (Objective Section)**

**Q1. Choose the correct option.** (8)

- (i) The highest unit to measure length is \_\_\_\_\_.
- a) millimetre      b) centimetre      c) metre      d) Kilometre
- (ii) A tricycle has 3 wheels 8 tricycles will have \_\_\_\_\_ wheels.
- a) 20      b) 24      c) 16      d) 36
- (iii) The three quarter of an hour is equal to \_\_\_\_\_ minutes.
- a) 15 min      b) 30 min      c) 45 min      d) 60 min
- (iv) A cuboid has \_\_\_\_\_ corners.
- a) 6      b) 8      c) 10      d) 12
- (v) The distance between 2 cities are measured in \_\_\_\_\_.
- a) Km      b) m      c) cm      d) mm
- (vi) How many hours are there in 10 days?
- a) 180 hours      b) 240 hours      c) 220 hours      d) 360 hours
- (vii) 1000 more than 5965 is \_\_\_\_\_
- a) 4965      b) 5965      c) 6965      d) None of these
- (viii) 15 m 9 cm is equal to \_\_\_\_\_ centimetre.
- a) 159 cm      b) 1509 cm      c) 15009 cm      d) None of these

**Q2. Match the Following.**

(6)

Column A	Column B
i. The face of a dice	(a) 75
ii. Unit to measure length of cricket pitch	(b) 12:35
iii. Number of division on face of clock	(c) Square
iv. Sum of 28 and 47 is	(d) 9
v. Number of hours between 5 am and 2 pm	(e) Metre
vi. 25 mins to 1 is	(f) 12

**Q3.** Mr. Gupta walks 4056 m everyday to keep himself fit. Find how much he walks everyday in Km and m. (2)

**Q4.** Write **True/False**. (2)

a) A candle looks bigger from near and smaller from far. \_\_\_\_\_

b) 30 days make a fortnight. \_\_\_\_\_

**Q5.** Write the time shown by the clock in 2 different ways? (2)

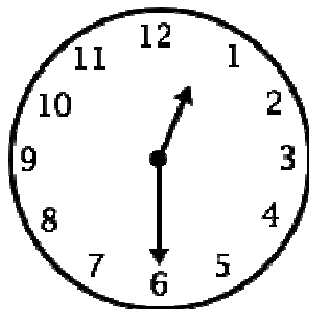

a)----- b) -----

**Q6.** 210 students from a school are going for a trip to Bhopal in school buses. The capacity of a bus is 35. How many buses are required for 210 students? (2)

**Q7.** Look at the Dice given below and answer the following questions. (2)



a) Which number is at the bottom?

b) Which number will be at the opposite of six ?

- Q8.** Tell the time in **AM/PM**. (2)
- a) The train arrives early morning at 4:15.
- b) The cricket match will telecast late night 11:55.

**Q9.** Draw the net of a Cylinder. (2)

**Q10.** Draw a **wall pattern** using basic shape of brick. (2)

**Section – B (Subjective Section)**

**Q11.** Draw the front, side and top view of Railway Track. (3)

**Q12** A forest had 2698 trees. 450 trees have been cut down. Find the number of trees left now? (3)

**Q13.** Simplify  $37495 - 12535 + 1004$ . (3)

**Q14.** Arrange in column and solve. (3)

- a) Add 15m, 1m99cm and 86cm                      b)  $40\text{km} - 24\text{km } 500\text{m}$

**Q15.** Draw Tessellations using: (Use minimum 12 units ) (3)

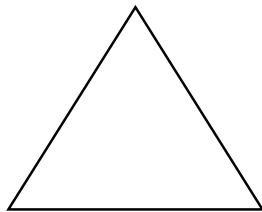

**Q16** Answer the following questions. (3)

- a) How many minutes are there between 5:20 PM and 5:45 PM?
- b) What will be the date 12 days before Republic day?
- c) If 8<sup>th</sup> July is Monday, then when will be the next Monday?

**Q17.** Fill in the blanks with Suitable answer. (4)

- a) If  $126 + 16 = 142$ , then  - 16 = 126.
- b) 1000 less than 1057 is
- c) Greatest 5 digit number using different digit is
- d)  $695 - \text{□} = 695$ .

**Q 18.** Mrs. Roy goes for a walk in a square field everyday to stay fit. If each side of the field is 500 m, find how many rounds she will take to cover 2 km? Also find the distance covered by her after 8 rounds.

**Q 19.** A hockey match started at 3:40 pm and ended at 5:05 pm. How long did the match last? (4)

**Q 20.** Look at the map of the XYZ school given below and answer the following the questions. (5)

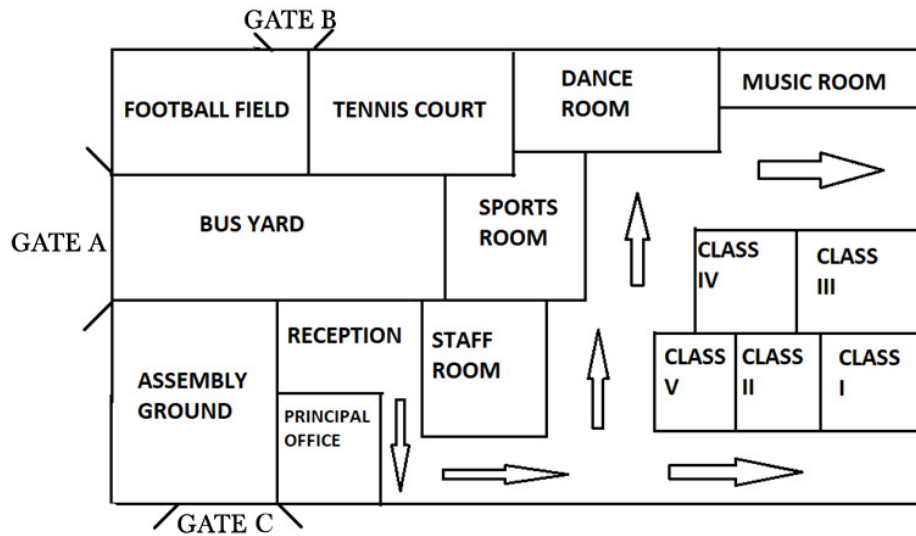

- Which class is behind class V?
- Which gate is nearer to Gate B? (Gate A or Gate C)
- If you enter from Gate B, where will you reach first?
- What is near to the principal's office? (Assembly Ground or Sports Room)
- Which room is between Tennis court and Music Room?

**Q 21.** Show the time by **drawing clocks**. Also convert them into 24-hour clock time. (5)

- 9:05 am
- Quarter past 6 in the evening

**Q22.** Solve the Following. (5)

- The cost of the 1000 bricks is Rs.1500. Rahman needs 12,000 bricks for his courtyard. How much will he have to pay?
- A truck can carry 50,00 bricks. How many bricks can be carried by 15 such trucks?

**Q23.** The following are the different kinds of boat along with ticket price and trip time.

S. No	Name of the Boat	Trip Time	Ticket Price
1.	Double Decker	45 Minutes	Rs. 100
2.	Paddleboat	30 Minutes	Rs. 75
3.	Motorboat	20 Minutes	Rs. 50
4.	Boat with oars	45 Minutes	Rs. 30

Now answer the following question based on above table: (5)

- How much you will pay if you want to ride all the boats?
- Which boat makes 2 trips in 1 hour?
- How much time it will take if you ride Motorboat and Double Decker boat?

